

DETAIL A

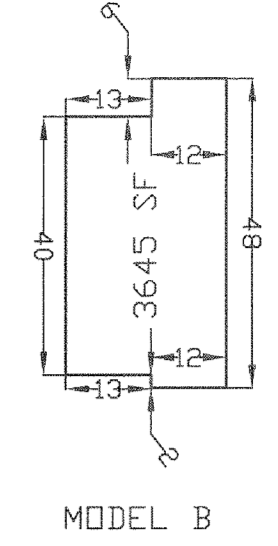
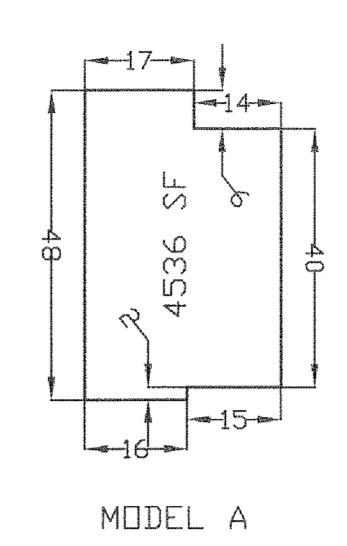

ROSEWOOD AT MADISON TOWNHOUSE CONDOMINIUMS

UNIT DETAILS  
1" = 30'

SHEET 22

SHEET 51

SHEET 52

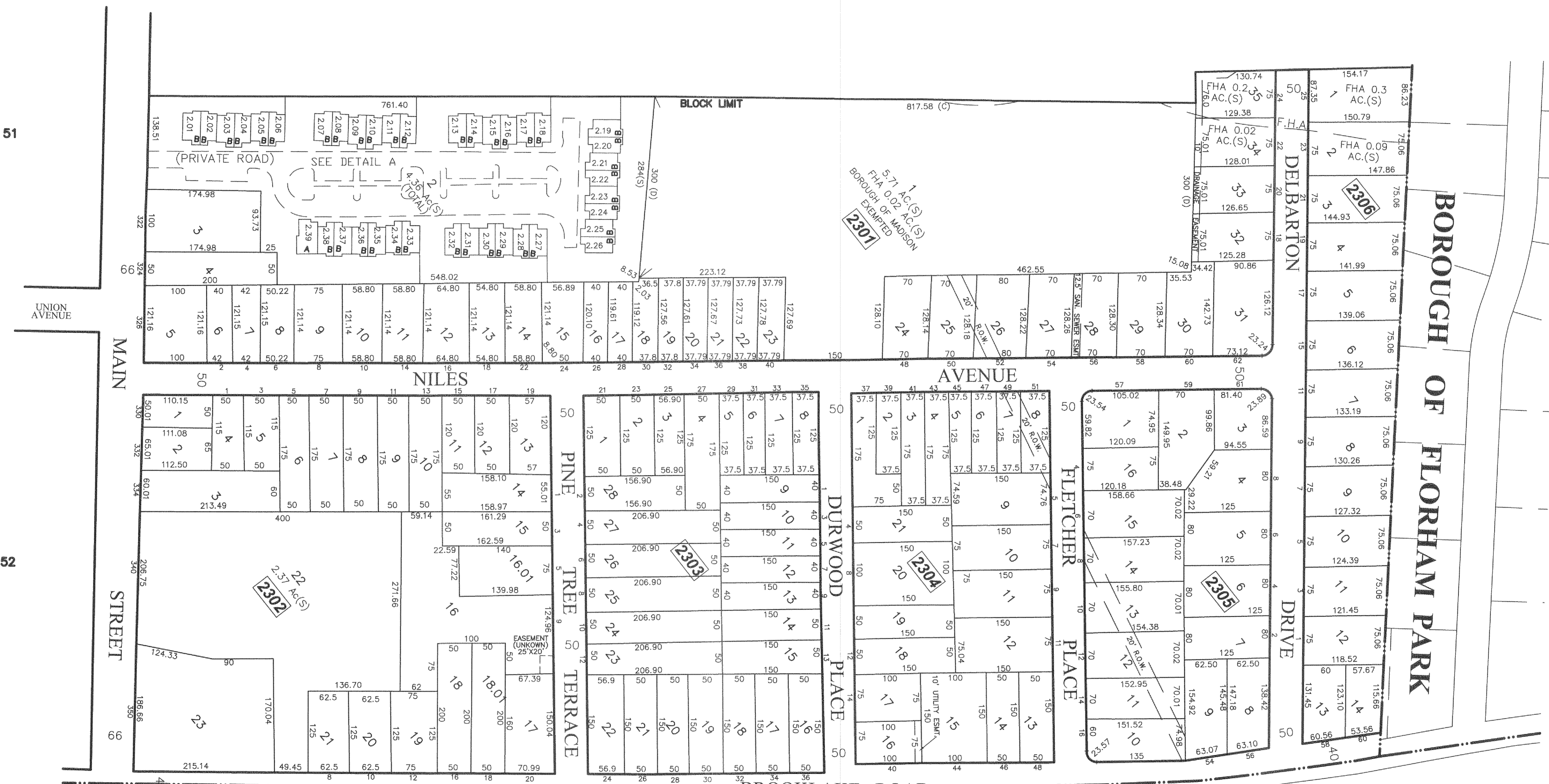

MAINTENANCE AND SUPERVISION OF TAX MAPS FOR THE BOROUGH PRIOR TO JANUARY 2016 WAS PERFORMED BY RICHARD F. SMITH, PLS. BEGINNING IN JANUARY 2016, MAINTENANCE AND SUPERVISION WAS PERFORMED BY ANDREW B. CLARKE, P.L.S., P.E. 6B04105600

DIVISION OF TAXATION,  
SIGNED BY:  
RICHARD F. SMITH, JR.,  
APPROVED BY:  
SUE DAVISON, CTA  
FEBRUARY 13, 2012, SERIAL # 921.

BOROUGH OF CHATHAM

NOTES:  
1. THIS SHEET HAS BEEN DRAWN USING COMPUTER AIDED DRAFTING/DESIGN.  
2. THIS SHEET IS A DIGITIZED COPY OF THE TAX MAP PREPARED BY RICHARD F. SMITH, JR. AND DATED 5-2-07 THE APPROVED ORIGINAL IS ON FILE IN THE ENGINEER'S OFFICE.

NO.	REVISION	DATE	BY	A.B.C.	APP'D
1.	ANDREW CLARKE, PLS & PE - GENERAL REVIEW	5/4/18	D.C.B.	A.B.C.	

**TAX MAP**  
BOROUGH OF MADISON  
MORRIS COUNTY, NEW JERSEY  
SCALE: 1"=100' DATE: 5-2-07  
RICHARD F. SMITH, JR.  
PROFESSIONAL LAND SURVEYOR NO. 24GSO2504800  
28 SCHUYLER PLACE  
MORRISTOWN, NJ 07960