

BOROUGH OF MADISON
BASEMENT ALTERATIONS CHECKLIST

1. Copy of contractor's current Home Improvement card.
2. Three (3) sets of building plans. All drawings must be signed by homeowner and include their name & address unless plans are drawn by a New Jersey licensed design professional.
3. Homeowner's plan certification section of application completed unless plans are drawn by a New Jersey licensed design professional.
4. Properly filled out applicable sub-code sections. Contractors must sign applications and electric and plumbing sub-code sections must have contractor's raised seal.
5. Include wiring diagram for electrical work (receptacles, switches, devices).
6. Provide framing detail.
7. Show wired smoke detector and carbon monoxide detector locations proposed on the floor plan.
8. Specify the use of the new space and label plan accordingly (playroom, laundry, office, etc.).
9. If bath or any other plumbing (sink for wet bar) is proposed a plumbing riser diagram is required.
10. Must fire block perimeter (see attached).

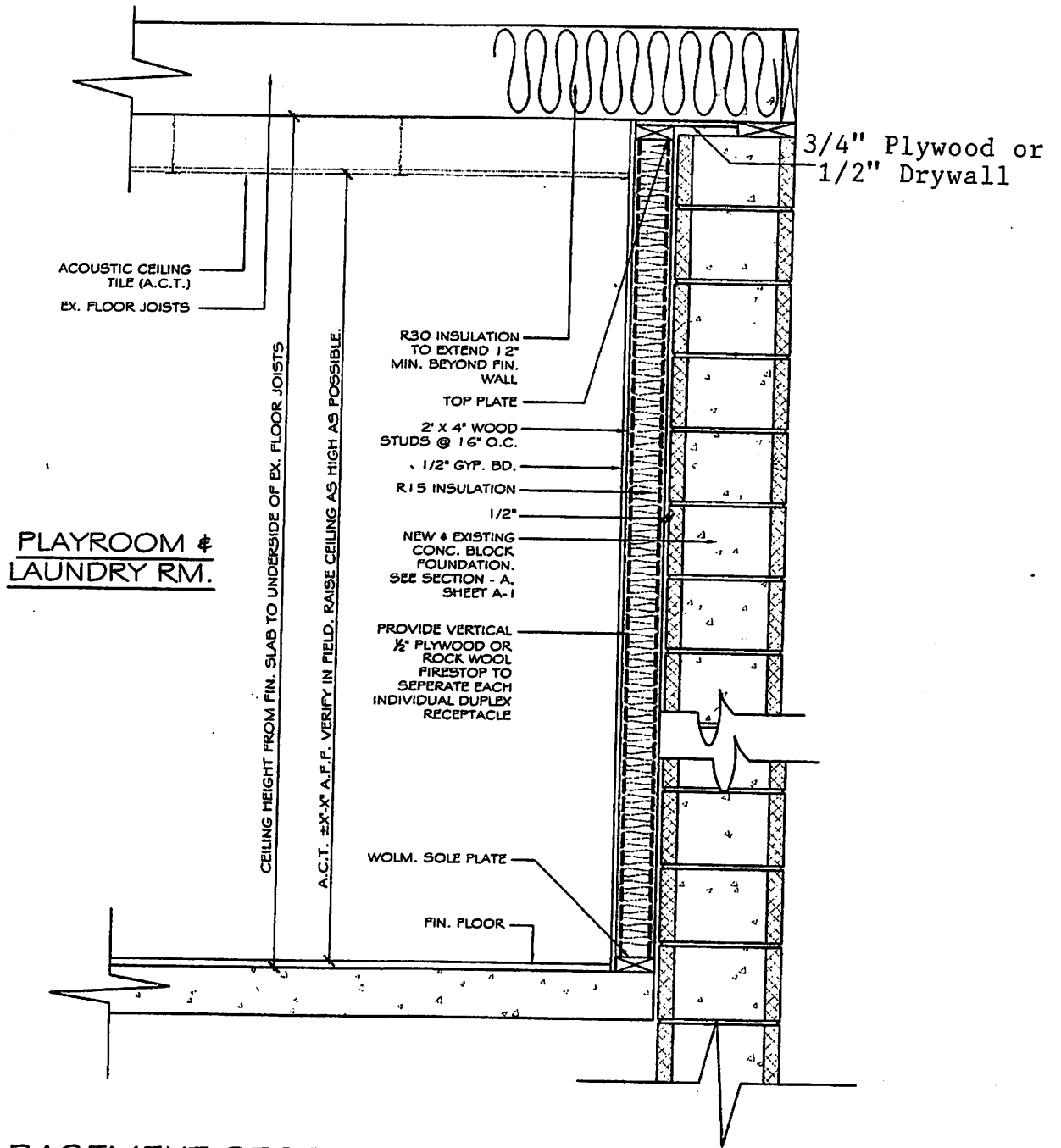

BASEMENT SECTION
 SCALE: N.T.S.

