

THE MADISON COMMON CONDOMINIUMS
UNIT DETAILS
1" = 30'

SHEET 6.01

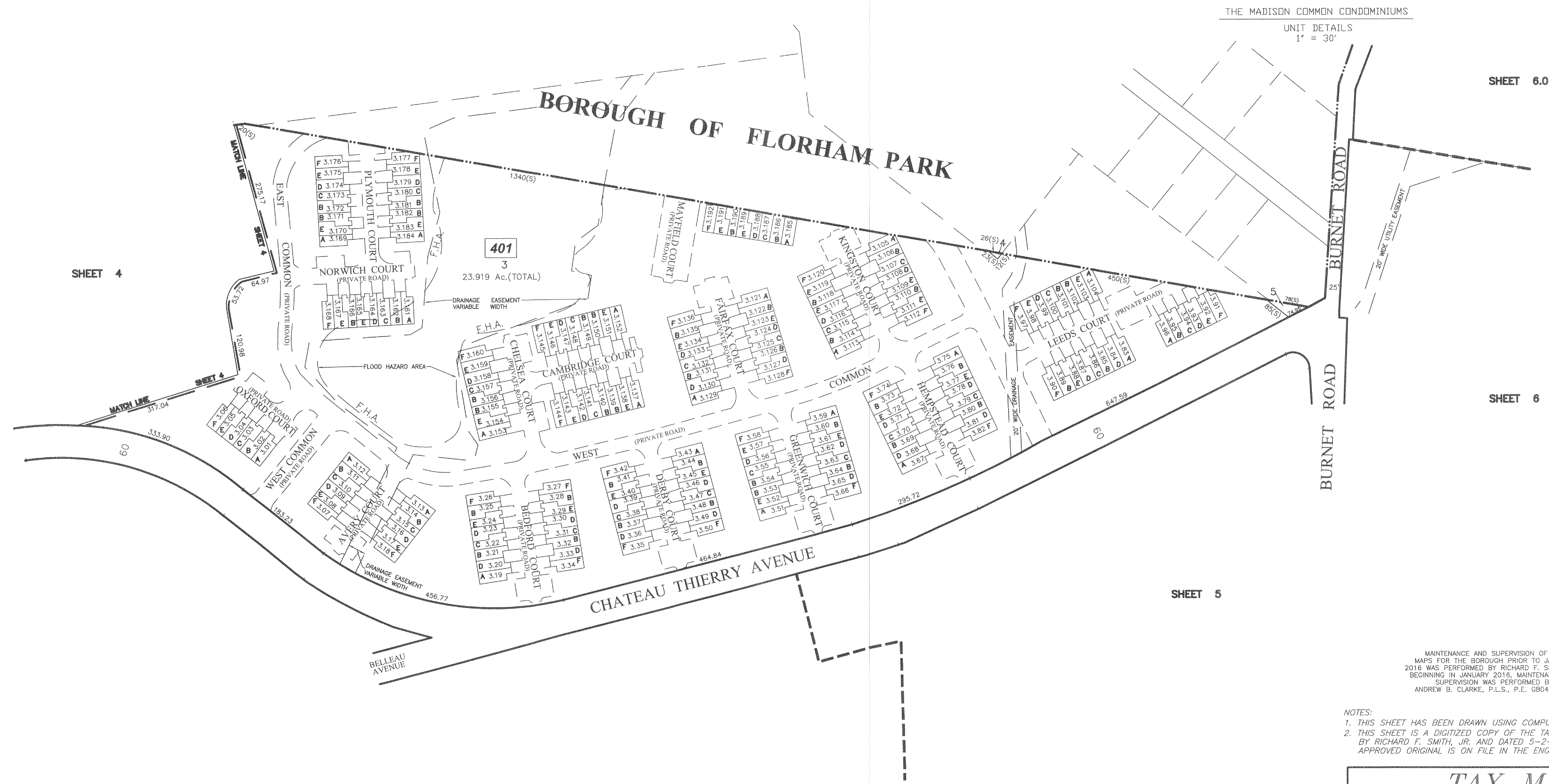

SHEET 4

SHEET 6

SHEET 5

SHEET 4

MAINTENANCE AND SUPERVISION OF TAX MAPS FOR THE BOROUGH PRIOR TO JANUARY 2016 WAS PERFORMED BY RICHARD F. SMITH, PLS. BEGINNING IN JANUARY 2016, MAINTENANCE AND SUPERVISION WAS PERFORMED BY ANDREW B. CLARKE, P.L.S., P.E. GB04105600

NOTES:
1. THIS SHEET HAS BEEN DRAWN USING COMPUTER AIDED DRAFTING/DESIGN.
2. THIS SHEET IS A DIGITIZED COPY OF THE TAX MAP PREPARED BY RICHARD F. SMITH, JR. AND DATED 5-2-07 THE APPROVED ORIGINAL IS ON FILE IN THE ENGINEER'S OFFICE.

TAX MAP
BOROUGH OF MADISON
MORRIS COUNTY, NEW JERSEY
SCALE: 1"=100' DATE: 5-2-07
RICHARD F. SMITH, JR.
PROFESSIONAL LAND SURVEYOR NO. 246S02504800
28 SCHUYLER PLACE
MORRISTOWN, NJ 07960

NO.	REVISION	DATE	BY	APP'D
1.	ANDREW CLARKE, PLS & PE - GENERAL REVIEW	5/4/18	D.C.B.	A.B.C.

DIVISION OF TAXATION,
SIGNED BY:
RICHARD F. SMITH JR.,
APPROVED BY:
SUE DAVISON, CTA
FEBRUARY 13, 2010, SERIAL # 921.

\storagesrv\Engineering\CAD Files\2015 TAX MAP ANDREW CLARK L5\004.01.dwg, 004.01, 5/3/2018 12:17:54 PM, KIP 3000 Series