



**GEORFFREY L. COGAN**  
 Architect, Planner, A.I.A., N.J. CERT. 21A00065600  
 8 KING STREET, 5TH FL., ROBERTSON, N.J. 07068  
 TEL: 908.353.2453 FAX: 908.353.2454  
 EMAIL: GC@GOGANL.COM

**DERCK & REDSON**  
 EST. 1940  
 CAMPUSES: DOWNTOWNS, ATHLETICS  
 38 SOUTH BRADDOCK STREET, LINTZ PA 17543  
 3011 SPRING STREET, SUITE 200, BELLEVILLE, PA 19803  
 (717) 262-2024  
 WWW.DERCKANDREDSON.COM

**CODE SUMMARY PLAN**  
 AMENDED PRELIMINARY / FINAL SITE DEVELOPMENT PLAN  
**FAIRLEIGH DICKINSON ATHLETIC FIELDS**  
 FAIRLEIGH DICKINSON UNIVERSITY  
 LOT 6 'B' BLOCK 101 ZONE 5B  
 285 MADISON AVENUE  
 MADISON BOROUGH, MORRIS COUNTY, NEW JERSEY

REVISIONS:		
No.	DATE	DESCRIPTION OF CHANGES

DATE:	02/05/2020
PROJECT #:	190450
DRAWN BY:	JTW
PK:	JLL
PI:	SES

DRAWING NO. **G-003**

# CODE ANALYSIS / BUILDING INFORMATION

## CODE SUMMARY

FAIRLEIGH DICKINSON UNIVERSITY- FLORHAM CAMPUS  
 BASEBALL STADIUM  
 285 MADISON AVENUE, MADISON, NJ 07940

**APPLICABLE CODES**  
 2018 INTERNATIONAL BUILDING CODE  
 2015 NEW JERSEY STATE FIRE CODE  
 2018 NATIONAL STANDARD PLUMBING CODE  
 2018 INTERNATIONAL MECHANICAL CODE  
 2017 NATIONAL ELECTRICAL CODE/NFPA 70  
 2016 ASHRAE 90.1 (COMMERCIAL)  
 2009 ICC/ANSI A117.1

**BUILDING DATA**  
**CONSTRUCTION TYPE**  
 IIB NON-COMBUSTIBLE AT BLEACHERS AND PRESS BOX  
 IIB NON-COMBUSTIBLE AT DUGOUTS

**BUILDING AREA (SOFTBALL FIELD)**  
 PRESSBOX LEVEL 144 SQUARE FEET  
**TOTAL AREA 144 SQUARE FEET**

**HEIGHT: 26'-2"**  
**STORIES ABOVE GRADE: ONE (PRESSBOX)**

## CHAPTER 3 - USE AND OCCUPANCY CLASSIFICATION

SECTION 302 CLASSIFICATION  
**ASSEMBLY (SEE SECTION 303); GROUP 'A-5'**

## CHAPTER 5 - GENERAL BUILDING HEIGHTS AND AREAS

**TABLE 503 ALLOWABLE HEIGHT AND BUILDING AREAS**  
 ASSEMBLY (A-5) OCCUPANCY, CONSTRUCTION TYPE VB, UNLIMITED SF, UNLIMITED STORIES, 40' MAXIMUM HEIGHT WITHOUT APPLYING BUILDING AREA MODIFICATIONS

**TABLE 508.2.5 INCIDENTAL ACCESSORY OCCUPANCIES**  
 MECHANICAL ROOM AND LAUNDRY ROOM TO BE 1-HOUR RATED

## CHAPTER 6 - TYPES OF CONSTRUCTION

**TABLE 601 FIRE-RESISTANCE RATING REQUIREMENTS FOR BUILDING ELEMENTS (HOURS)**  
 TYPE IIB CONSTRUCTION REQUIRES A ZERO HOUR FIRE RATINGS OF ALL STRUCTURAL ELEMENTS

## CHAPTER 8 - INTERIOR FINISHES

**TABLE 803.11 INTERIOR WALL AND CEILING FINISH REQUIREMENTS BY OCCUPANCY:**  
 FOR (A-5) OCCUPANCY WITHOUT SPRINKLER SYSTEM: EXIT ENCLOSURES AND EXIT PASSAGEWAYS (A); CORRIDORS (A); ROOMS AND ENCLOSED SPACES (C)

## CHAPTER 9 - FIRE PROTECTION SYSTEMS

SECTION 906 PORTABLE FIRE EXTINGUISHERS  
**906.1 WHERE REQUIRED.** PORTABLE FIRE EXTINGUISHERS SHALL BE INSTALLED IN THE FOLLOWING LOCATIONS.  
 1. IN AREAS WHERE FLAMMABLE OR COMBUSTIBLE LIQUIDS ARE STORED, USED, OR DISPENSED  
 2. ON EACH FLOOR OF STRUCTURES UNDER CONSTRUCTION, EXCEPT GROUP R-3 OCCUPANCIES, IN ACCORDANCE WITH SECTION 1415.1 OF THE INTERNATIONAL FIRE CODE.

## CHAPTER 10 - MEANS OF EGRESS

TABLE 1004.1.1. OCCUPANT LOAD CALCULATIONS ARE SHOWN ON THE CODE SUMMARY PLANS ON THIS DRAWING SHEET  
**1005.1 MINIMUM REQUIRED EGRESS WIDTH.** THE TOTAL WIDTH OF MEANS OF EGRESS IN INCHES SHALL NOT BE LESS THAN THE TOTAL OCCUPANT LOAD SERVED BY THE MEANS OF EGRESS MULTIPLIED BY 0.3" PER OCCUPANT FOR STAIRWAYS AND BY 0.2" PER OCCUPANT FOR OTHER EGRESS COMPONENTS.  
**1014.3 COMMON PATH OF EGRESS TRAVEL**  
 IN OCCUPANCIES OTHER THAN GROUPS H1, H2, AND H3, THE COMMON PATH OF EGRESS TRAVEL SHALL NOT EXCEED 75 FEET.  
**TABLE 1016.1 EXIT ACCESS TRAVEL DISTANCE**  
 ASSEMBLY (A) OCCUPANCY WITHOUT SPRINKLER SYSTEM: 200 FEET

## CHAPTER 12 - INTERIOR ENVIRONMENT

**1208.1 MINIMUM ROOM WIDTHS.** HABITABLE SPACES, OTHER THAN A KITCHEN, SHALL NOT BE LESS THAN 7 FEET IN ANY PLAN DIMENSION. KITCHENS SHALL HAVE A CLEAR PASSAGEWAY OF NOT LESS THAN 3 FEET BETWEEN COUNTER FRONTS AND APPLIANCES OR COUNTER FRONTS AND WALLS.

## 2015 INTERNATIONAL ENERGY CONSERVATION CODE SUMMARY

CHAPTER 3 CLIMATE ZONES - MORRIS COUNTY, NJ ZONE 5A (MOIST)

## CHAPTER 5 COMMERCIAL ENERGY EFFICIENCY

**TABLE 402.2 OPAQUE THERMAL ENVELOPE REQUIREMENTS**  
 ROOFS, ATTIC AND OTHER - R38  
 WALLS, MASS WALL - R11.4 CONTINUOUS INSULATION  
 SLAB-ON-GRADE FLOORS - R10 FOR 24" BELOW (UNHEATED)  
 OPAQUE DOORS - SWINGING (U-0.37); ROLL-UP (R-4.75)  
 METAL WINDOWS w/ THERMAL BREAK (OPERABLE) - U-0.45  
 METAL WINDOWS w/ THERMAL BREAK (FIXED) - U-0.30

### EGRESS SYMBOL LEGEND

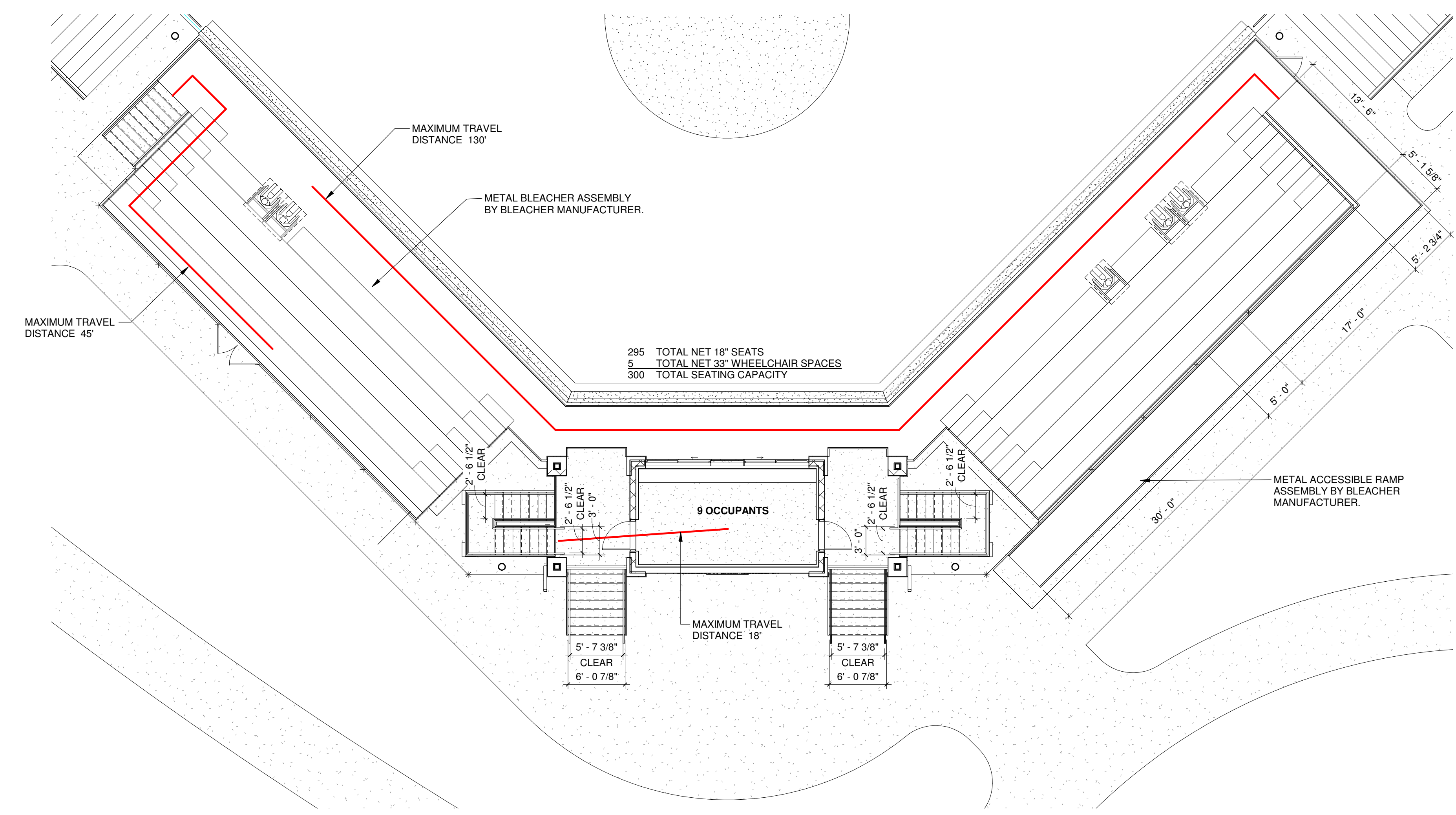
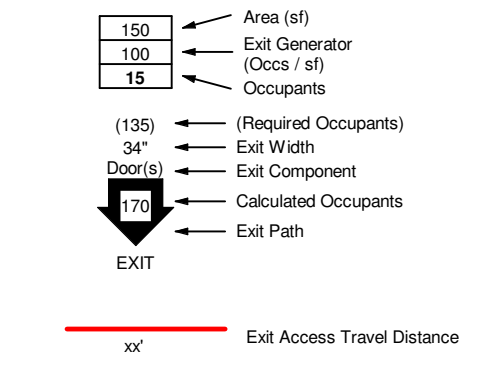

**1 PRESSBOX / BLEACHERS CODE SUMMARY PLAN**  
 1/8" = 1'-0"

## NOTES:

- REFER TO PROJECT MANUAL FOR EXTINGUISHER AND CABINET TYPES
- CONFIRM FINAL LOCATIONS AND MOUNTING HEIGHTS WITH ARCHITECT PRIOR TO INSTALLATION

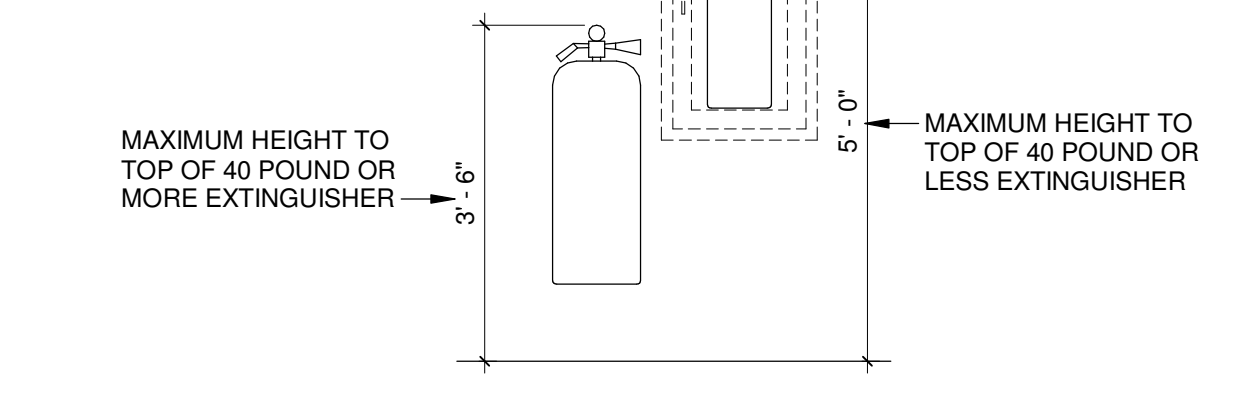

**2 FIRE EXTINGUISHER DETAIL**  
 1/2" = 1'-0"