

BOROUGH OF FLORHAM PARK

SHEET 7

SHEET 10

SHEET 50

SHEET 19

SHEET 21

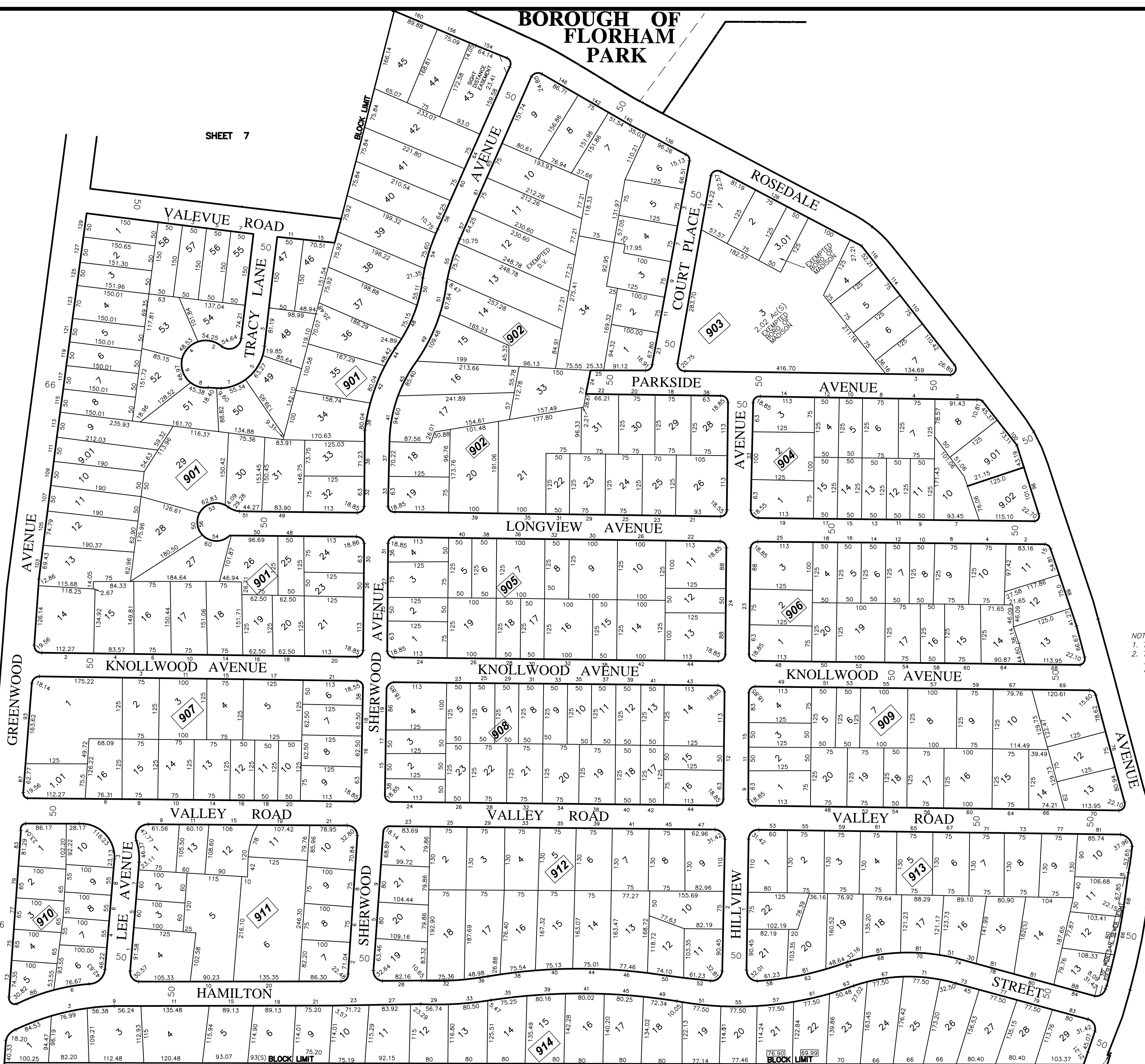

MAINTENANCE AND SUPERVISION OF TAX MAPS FOR THE BOROUGH PRIOR TO JANUARY 2016 WAS PERFORMED BY RICHARD F. SMITH, PLS. BEGINNING IN JANUARY 2016, MAINTENANCE AND SUPERVISION WAS PERFORMED BY ANDREW B. CLARKE, P.L.S., P.E. GB04105600

- NOTES:
1. THIS SHEET HAS BEEN DRAWN USING COMPUTER AIDED DRAFTING/DESIGN.
 2. THIS SHEET IS A DIGITIZED COPY OF THE TAX MAP PREPARED BY RICHARD F. SMITH, JR. AND DATED 5-2-07 THE APPROVED ORIGINAL IS ON FILE IN THE ENGINEER'S OFFICE.

DIVISION OF TAXATION,
SIGNED BY:
RICHARD F. SMITH JR.,
APPROVED BY:
SUE DAVISON, CTA
FEBRUARY 13, 2012, SERIAL # 921.

SHEET NO.	REVISION	DATE	BY	APP'D
22	2. ANDREW CLARKE, PLS & PE - GENERAL REVIEW	9/20/19	D.C.B.	A.B.C.
1.	ANDREW CLARKE, PLS & PE - GENERAL REVIEW	5/4/18	D.C.B.	A.B.C.

TAX MAP
 BOROUGH OF MADISON
 MORRIS COUNTY, NEW JERSEY
 SCALE: 1"=100' DATE: 5-2-07
 RICHARD F. SMITH, JR.
 PROFESSIONAL LAND SURVEYOR NO. 24GS02504800
 28 SCHUYLER PLACE
 MORRISTOWN, NJ 07960

\\storagesrv\Engineering\CAD Files\2015 TAX MAP ANDREW CLARK LS\009.dwg, 009, 1/7/2020 4:02:24 PM, bucktelewd, DWG To PDF.pc3