

# ROSEN KELLY CONWAY

*David M. Rosen*

DAVID M. ROSEN, AIA, LEED AP  
NJ - AI 08664 NY - 025464

July 09, 2020

JOHN H. KELLY, JR., AIA, LEED AP  
NJ - AI 11116

THOMAS A. CONWAY, AIA, LEED AP  
NJ - AI 17846

16 Maple Street Summit NJ 07901  
908 273 6565 rkcad.com

Revision	07.09.20
Issued for Variance	07.02.20
Description	Date

**ROGERS RESIDENCE**  
1 DELLWOOD DRIVE  
MADISON, NJ  
Lot: 1 Block: 4903

PROPOSED FIRST FLOOR PLAN

# V-3

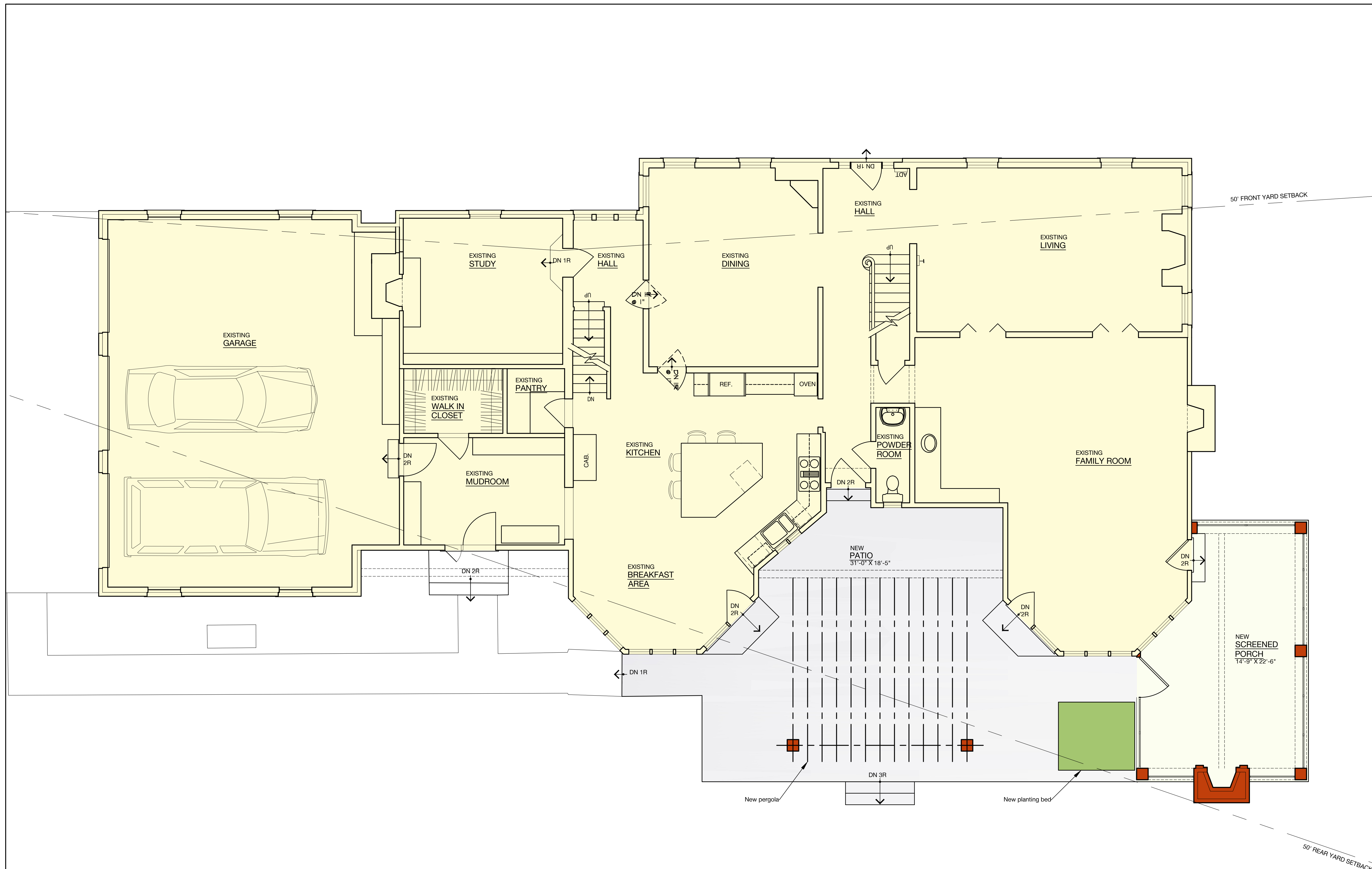

**1** **PROPOSED FIRST FLOOR PLAN**  
V-3 SCALE: 1/4" = 1'-0"