

**BOROUGH OF MADISON**

**LIST OF PROPERTY OWNERS  
WITHIN A 200' RADIUS**

**TO BE SERVED FOR ZONING VARIANCES AND/OR  
SUBDIVISION AND/OR SITE PLAN APPLICATIONS**

*I certify that the attached list is an accurate and complete list of property owners and their addresses. They must be given notice pursuant to the requirements of N.J.S.A. 40:50-7.1. Said list has been prepared for the most recent tax rolls of the Borough of Madison. This list is only valid for 60 days.*

**SIGNATURE:**

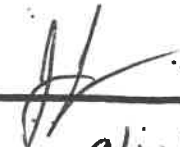

**DATE:**

9/14/20

**OWNER:**

David + Theresa Blackwell

**ADDRESS:**

6 Washington St.

**APPLICANT:**

Theresa Blackwell

**COMPANY:**

N/A

**BLOCK/LOT:**

3202/36

**REPORT:**

20-32

**PAYMENT**

**TYPE:**

CASH ( ) CHECK  # 4569

**PAYMENT**

**DATE:**

9/11/20

**REQUEST FOR 200' LIST**

**\$10.00 FEE-PAYABLE TO:  
THE BOROUGH OF MADISON**

**THIS LIST IS VALID FOR 60 DAYS ONLY**

N.J.S. 40:55D-12c provides that, upon written request of an applicant, the "administrative officer" of a municipality shall, **within SEVEN DAYS**, make and certify a list from the current tax duplicate of names and addresses of owners to whom the applicant is required to give notice.

*David + Theresa*

NAME: Dave & Tracy Blackwell

ADDRESS: 6 Washington Drive

BLOCK: 3702 LOT: 36

PHONE NUMBER: 201-400-2617

DATE REQUESTED: 9/19/20

*tblackwell@fingerpaint.com*

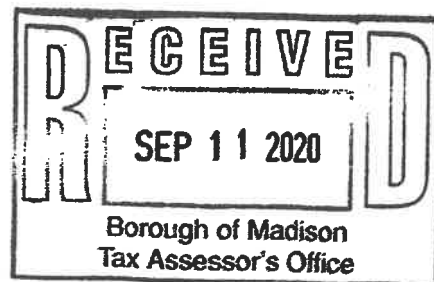

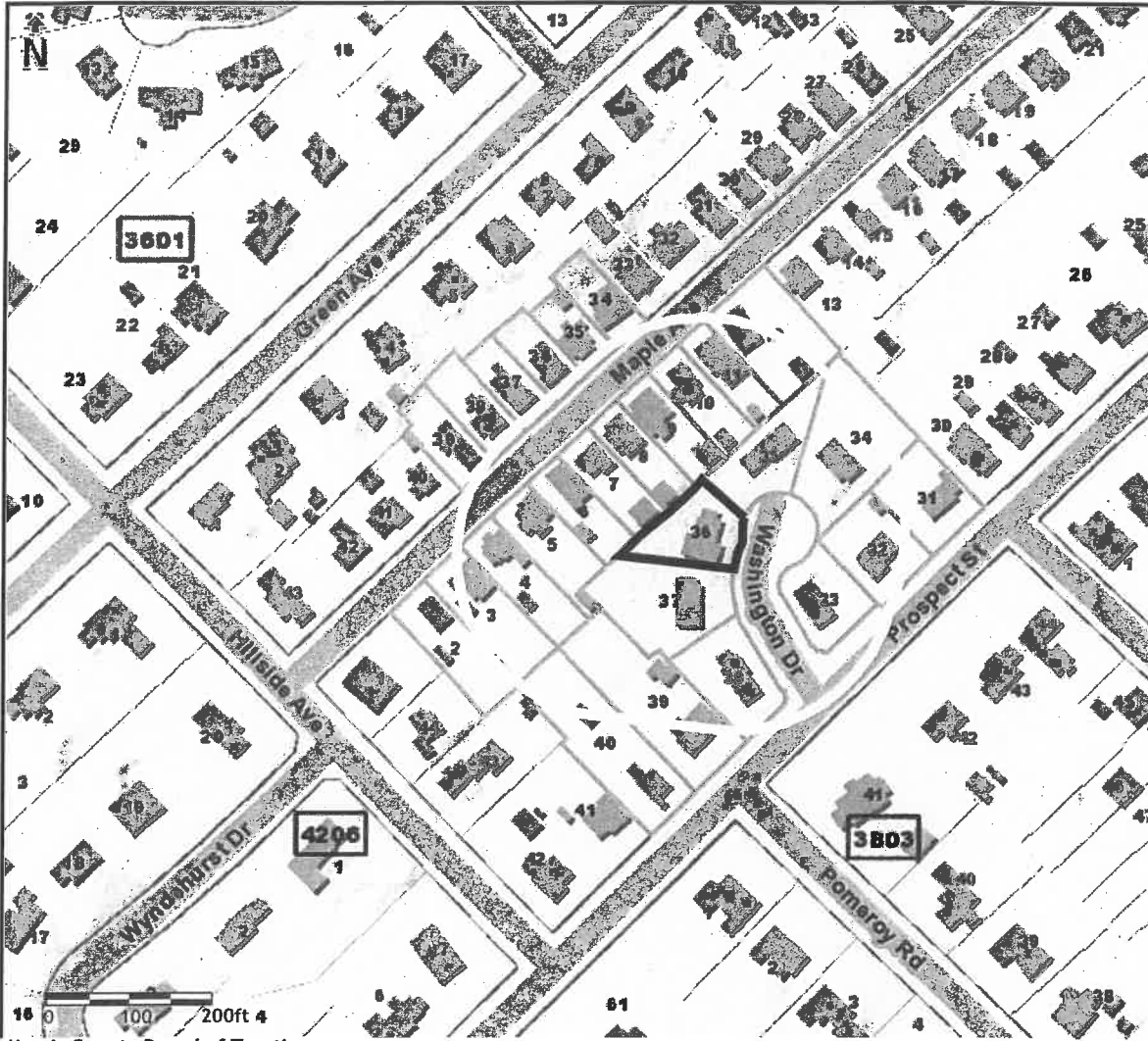

Morris County Board of Taxation  
 COUNTY OF MORRIS, NEW JERSEY  
 P.O. Box 900, Morristown NJ, 07963-0900  
 \*Maximum of 500 records available on report

Projection: State Plane (FIPS 2900)  
 Datum: NAD83  
 Units: Feet

Morris County GIS Services, NJ, USA - © 2011-2016

The maps and data available for access at this website is provided "as-is" without warranty or any representation of accuracy, timeliness, or completeness. The burden for determining accuracy, completeness, timeliness, merchantability and fitness for, or the appropriateness for use, rests solely on the user accessing this information. The County of Morris makes no warranties, express or implied, as to the use of the maps and the data available for access at this website. There are no implied warranties of merchantability or fitness for a particular purpose. The user acknowledges and accepts all inherent limitations of the maps and data, including the fact that the maps and data are dynamic and in a constant state of maintenance, correction, and revision. The maps and associated data at this website do not represent a survey. In no event shall the County of Morris or its officers or employees assume any liability for the accuracy of the data delineated on any map. In no event shall the County of Morris or its officers or employees be liable for any damages arising in any way out of the use of this information.

TARGETED PROPERTIES:				
PAMS_PIN	Acres	Property Location	Owners Name	Mailing Address
1417_3702_36	0.2330	6 WASHINGTON DR	BLACKWELL, DAVID M/THERESA	6 WASHINGTON DR MADISON, NJ 07940

PARCELS WITHIN RANGE OF TARGETED PROPERTIES:				
PAMS_PIN	Acres	Property Location	Owners Name	Mailing Address
1417_3701_33	0.1607	41 MAPLE AVE	NOWAK, RICHARD A JR & DAWN E	41 MAPLE AVE MADISON, NJ 07940
1417_3701_34	0.1366	43 MAPLE AVE	MOYAD, ANDREW & STICKEL, CYNTHIA	43 MAPLE AVE MADISON, NJ 07940
1417_3701_35	0.1033	45 MAPLE AVE	RILEY, DAVID J & BETH ANNE	45 MAPLE AVE MADISON, NJ 07940
1417_3701_36	0.1263	47 MAPLE AVE	SHEEHY, JEANNIE M.	47 MAPLE AVE MADISON, NJ 07940
1417_3701_37	0.1263	49 MAPLE AVE	FREED, KAREN A & DRESBOLD, PAUL	49 MAPLE AVE MADISON, NJ 07940
1417_3701_38	0.1591	51 MAPLE AVE	BIBBEE, CHARLES & MARY	51 MAPLE AVE MADISON, NJ 07940
1417_3701_39	0.1433	53 MAPLE AVE	WRIEDEN, K C/O WRIEDEN, DAN	97 WAYNE ST JERSEY CITY, NJ 07302
1417_3702_10	0.1550	44 MAPLE AVE	MARFIL, ANTONIO/ALVAREZ, PATRICIA	44 MAPLE AVE MADISON, NJ 07940
1417_3702_11	0.1550	42 MAPLE AVE	WOOD, KEVIN P	42 MAPLE AVE MADISON, NJ 07940
1417_3702_12	0.3099	40 MAPLE AVE	ITALIANO, FRANCIS & ANNA	40 MAPLE AVE MADISON, NJ 07940
1417_3702_2	0.2383	60 MAPLE AVE	CONLEY, BLAIR R/DONNA D	60 MAPLE AVE MADISON, NJ 07940
1417_3702_3	0.2448	58 MAPLE AVE	LITOW, JENNIFER & SADOWSKI, ROBERT	58 MAPLE AVE MADISON, NJ 07940
1417_3702_31	0.2583	55 PROSPECT ST	GABURO, LOUIS M & PATRICIA G	55 PROSPECT ST MADISON, NJ 07940
1417_3702_32	0.2583	59 PROSPECT ST	CHANG, HOWARD & BELINDA	59 PROSPECT ST MADISON, NJ 07940
1417_3702_33	0.2429	1 WASHINGTON DR	NEUMANN, CHRISTOPHER & ELIZABETH	1 WASHINGTON DR MADISON, NJ 07940
1417_3702_34	0.4386	3 WASHINGTON DR	BAULIG, DANIEL & MADELINE PASKE	3 WASHINGTON DR MADISON, NJ 07940
1417_3702_35	0.1965	5 WASHINGTON DR	NATALE, PATRICK C/LAUREN	5 WASHINGTON DR MADISON, NJ 07940
1417_3702_36	0.2330	6 WASHINGTON DR	BLACKWELL, DAVID M/THERESA	6 WASHINGTON DR MADISON, NJ 07940
1417_3702_37	0.3316	4 WASHINGTON DR	BALDAUF, ANDREW J. & BARBARA A.	4 WASHINGTON DR MADISON, NJ 07940
1417_3702_38	0.2517	2 WASHINGTON DR	FLAHERTY, JOSEPHINE A.	2 WASHINGTON DR MADISON, NJ 07940
1417_3702_39	0.5280	73 PROSPECT ST	VACCA, JOY & SOVETTS, MARIA V	108 PLEASANTVILLE RD NEW VERNON, NJ 07976
1417_3702_4	0.2053	56 MAPLE AVE	GAJEWSKI, EDWARD	56 MAPLE AVE MADISON, NJ 07940
1417_3702_40	0.4304	75 PROSPECT ST	FRIEDER, DAVID A & AMY B	75 PROSPECT ST MADISON, NJ 07940
1417_3702_43	0.3610	58 HILLSIDE AVE	WRIGHT, GLEN C & SCHWETJE, ANN M	58 HILLSIDE AVE MADISON, NJ 07940
1417_3702_5	0.2369	54 MAPLE AVE	HUBER, HERMAN & ANN A	54 MAPLE AVE MADISON, NJ 07940

PAMS_PIN	Acres	Property Location	Owners Name	Mailing Address
1417_3702_6	0.1550	52 MAPLE AVE	ABRUZZO, THOMAS/PATRICIA	52 MAPLE AVE MADISON, NJ 07940
1417_3702_7	0.1550	50 MAPLE AVE	MC DONALD, JUDITH A	50 MAPLE AVE MADISON, NJ 07940
1417_3702_8	0.1550	48 MAPLE AVE	HADIM,HAMID A/KAHINA	48 MAPLE AVE MADISON, NJ 07940
1417_3702_9	0.1550	46 MAPLE AVE	ERICKSON, LAURIE J & UPTON, DAVID	46 MAPLE AVE MADISON, NJ 07940

*In accordance with STATE law you must notify the following utility companies listed in the Borough of Madison.*

**GAS**

**Public Service Electric and Gas Company  
Manager- Corporate Properties  
80 Park Plaza, T6B  
Newark, New Jersey 07102**

**TELEPHONE**

**Verizon of New Jersey - Highlands  
Paul Grosso, ROW Department  
290 W Mt. Pleasant Avenue - Room 40D2  
Livingston, New Jersey 07039**

**CABLE**

**Cablevision of Morris  
Hollis Orderson, Engineering Department  
683 Route 10 East  
Randolph, New Jersey 07869-3799**

*If the property is adjacent to a County Road, legal notice must be sent to the following:*

**Morris County Planning Board  
P.O. Box 900  
Morristown, New Jersey 07963**

*If the property is adjacent to a State Highway, legal notice must be sent to the following:*

**N.J.D.O.T.  
1035 Parkway Avenue  
CN 600  
Trenton, New Jersey 08625**

**If the property is within 200' of an adjoining municipality, legal notice must be sent to the Clerk of said municipality. A 200' list of property owners will also need to be obtained and notified.**